

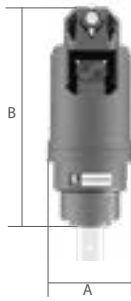

THE ATC MODEL AUGER IS BUILT IN HIGH QUALITY STEEL AND DESIGNED FOR EFFECTIVE, RAPID BORING THANKS TO AUGER LENGTH OPTIMISED IN RELATION TO ITS DIAMETER. THE CONSTANT SPIRAL CUTTING ENABLES THE TEETH TO BE PLACED AT ANGLES TO OPTIMISE DIGGING AND THUS DIRECT SPOIL TOWARDS THE MIDDLE OF THE AUGER, WHERE IT WILL BE THOROUGHLY CRUSHED TO AVOID ANY CLOGGING. WITH A VARIETY OF COMBINATIONS, AUGERS ARE VERSATILE AND CAN BE ADAPTED FOR SOFT, ROCKY, MIXED AND EVEN FROZEN GROUND. THE AUGER IS SUPPLIED COMPLETE WITH TWO-HOSE KIT.



	TONS (LB)	1,0 - 2,0 (2205 - 4409)	1,5 - 3,0 (3307 - 6614)	2,5 - 4,5 (5512 - 9921)
MOOD.		ATC-F150	ATC-F250	ATC-F350
A	MM (IN)	205 (8)	205 (8)	244 (10)
B	MM (IN)	406 (16)	465 (18)	665 (26)
BIT COUPLING	MM (IN)	Ø65 (2,5)	Ø65 (2,5)	Ø65 (2,5)
kg WITHOUT COUPLING	KG (LB)	38 (80)	40 (86)	73 (161)
BIT ROTATION	RPM	44-98	36-87	42-90
MINIMUM - MAX	L/MIN (GAL/MIN)	20-45 (5,2 - 11,8)	27-65 (7,1 - 17,2)	40-85 (10,5 - 22,4)
MAX	BAR (PSI)	205 (2973)	240 (3480,9)	240 (3480,9)
MAX TORQUE	NM (FT/LBS)	1500 (1106,3)	2800 (1843,9)	3600 (2655,2)
AUGER BIT LENGTH	MM (IN)	1200 (47,2)	1200 (47,2)	1200 (47,2)
AUGER BIT CLASS		S4	S4	S4



STANDARD TECHNICAL FEATURES

- 1 PLANETARY REDUCTION GEARBOX**
USED FOR SPEED REDUCTION, IT GUARANTEES HIGH EFFICIENCY THANKS TO REDUCED ROTATION POWER EVEN ON MACHINES WITH LOW HYDRAULIC FLOW RATES.
- 2 TOOTH FIXING SYSTEM**
THE PATENTED TOOTH FIXING SYSTEM ENSURES SAFE LOCKING OF THE TEETH AND PROTECTS THEM AGAINST POSSIBLE IMPACT FRACTURES. THE TEETH ARE ARRANGED FOR OPTIMISED DIGGING.
- 3 FRONT ATTACHMENT INTERFACE**

NB : THE ATTACHMENT IS SUPPLIED COMPLETE WITH PIPES AND MACHINE ATTACHMENT

OPTIONAL

- 4 EXTENSION S4 1000MM**
- 5 STANDARD BIT S4**
SUITABLE FOR DRILLING GROUND OF AVERAGE CONSISTENCY, WITH OPTION OF REPLACING THE INSERTS AND BIT CENTRING DEVICE TO RESTORE THE INITIAL CONDITIONS.
- 6 ROCK BIT S4**
SUITABLE FOR DRILLING VERY HARD GROUND WITH ROCKS OR RUBBLE.
- 7 MT - ATC BIT ADAPTER (A) ATC - MT BIT ADAPTER (B)**
- 8 PRESSURE REDUCER VALVE**
AVAILABLE ON REQUEST



11

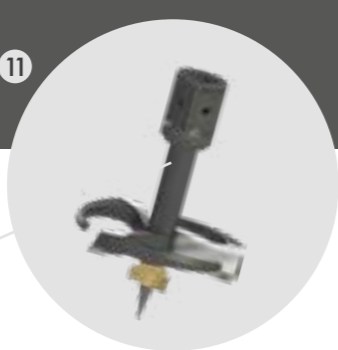

12



13

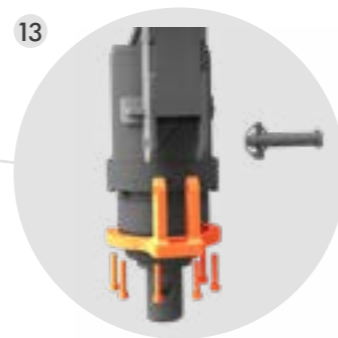

OPTIONAL

11 STUMP PLANER S4

FOR EFFECTIVE, EASY AND CLEAN REMOVAL OF TREE STUMPS OF ANY SIZE IN A SHORT TIME. IDEAL FOR SOIL PREPARATION AND FOREST MAINTENANCE.

12 LOG SPLITTER S4

THE LOG SPLITTER ATTACHMENT IS COMPACT AND ROBUST FOR EASY PROCESSING AND RECYCLING OF LOGS. THE CONICAL SHAPE MAKES ITS WAY INTO THE LOG, SPLITTING IT IN TWO.

13 SWING LOCK KIT

THE KIT IS RECOMMENDED TO FACILITATE THE USE OF THE LOG SPLITTER. MAKES THE DRILL BODY RIGID BY AIDING CONE CENTRING AND IMPROVING PRESSURE ON THE LOG. CLAMPING IS DONE BY MEANS OF THE BIT CONNECTION PIN.

BIT

		BIT COUPLING	150 Ø	200 Ø	250 Ø	300 Ø	350 Ø	400 Ø	500 Ø	600 Ø
7	STANDARD BIT S4	Ø65 (2,5)	•	•	•	•	•	•	•	•
8	ROCK BIT S4	Ø65 (2,5)	•	•	•	•	•	•	•	•

ACCESSORIES

		BIT COUPLING	DIAMETER MM (IN)	ATC150	ATC250	ATC350
11	STUMP PLANER S4	Ø65 (2,5)	250 (9,8)	•	•	•
11	STUMP PLANER S4	Ø65 (2,5)	350 (13,7)	•	•	•
12	LOG SPLITTER S4	Ø65 (2,5)	185 (7,3)		•	
13	SWING LOCK KIT	Ø65 (2,5)		•	•	•

